

RoHS

REV.	DESCRIPTION	DATE	DWG.	CHKD
0	PROPOSED	13/08/07	B.K	T.H

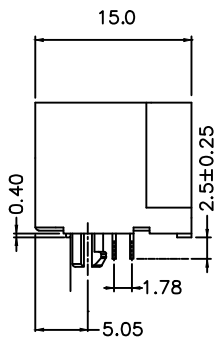
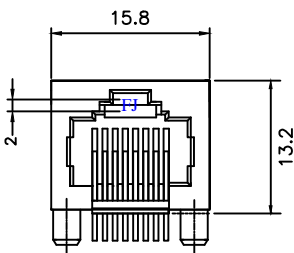

**SPECIFICATIONS**

**MATERIAL:**

1. Housing : PBT Polyester UL94V0
2. Color : Black
3. Contacts : 0.45mm Diameter Phos-Bronze Plated With Hard Gold

**ELECTRICAL:**

1. Current Rating : 1.5 AMP MAX
2. Voltage Rating : 150 VAC MAX
3. Contact Resistance : 30 milliohms MAX, initial
4. Insulation Resistance : 500 Megohms MIN
5. Dielectric Withstanding Voltage : 1000 VAC, 1min

UL. CUL NO.: E166003

**Part No.**

**M610-88X1-10031**

**Gold Plating**

- 1 - 3u"
- 2 - 6u"
- 3 - 15u"
- 4 - 30u"
- 5 - 50u"

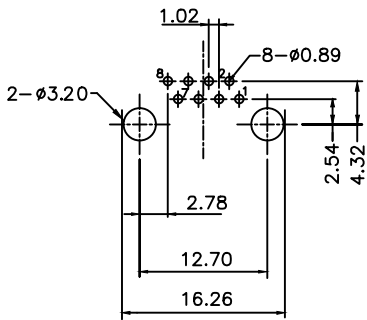
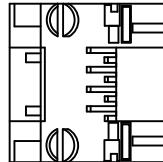

PCB LAYOUT/TOP VIEW

FINISH		NAME		PART NO.	
MATERIAL: *****	NET WEIGHT:	COLOR:	GENERAL TOLERANCE: ±0.2 ±3°	UNIT: mm	REV. ○
FIN. & TREAT: *****	GROSS WEIGHT:	SCALE:	SIZE: A3		REV. *
CUSTOMER: *****	PART NO.: M610-88X1-10031				
CUSTOMER PART NO.: *****	PROPOSAL NO.: M610-88X1-10031				
美星鴻科技股份有限公司 MSH TECHNOLOGY INC.		NAME: RJ45 Side Entry Modular Jack			
APP: 13/08/07	DWG: 13/08/07	DATE: 13/08/07			
T.HASHIMOTO	T.HASHIMOTO	B.KA	SHEET 1 OF 1		