

6

5

4

3

2

1

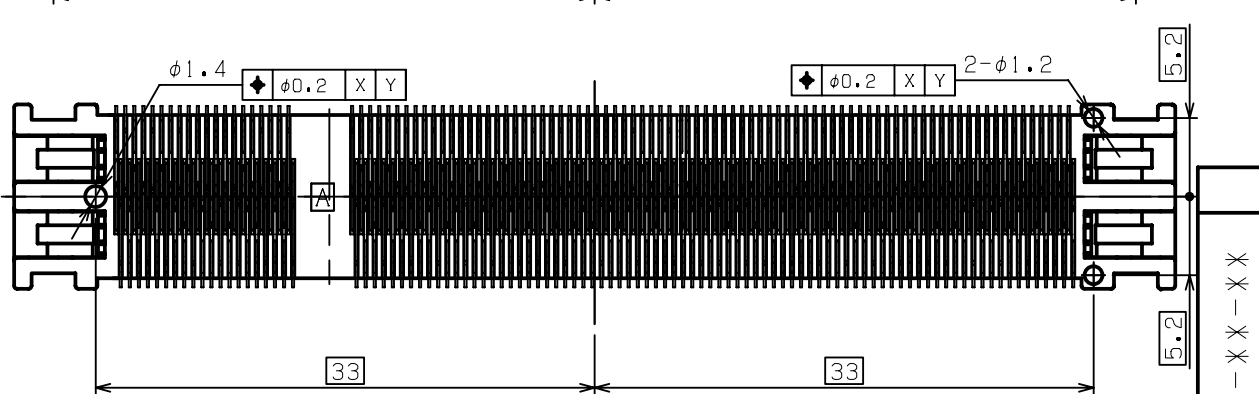
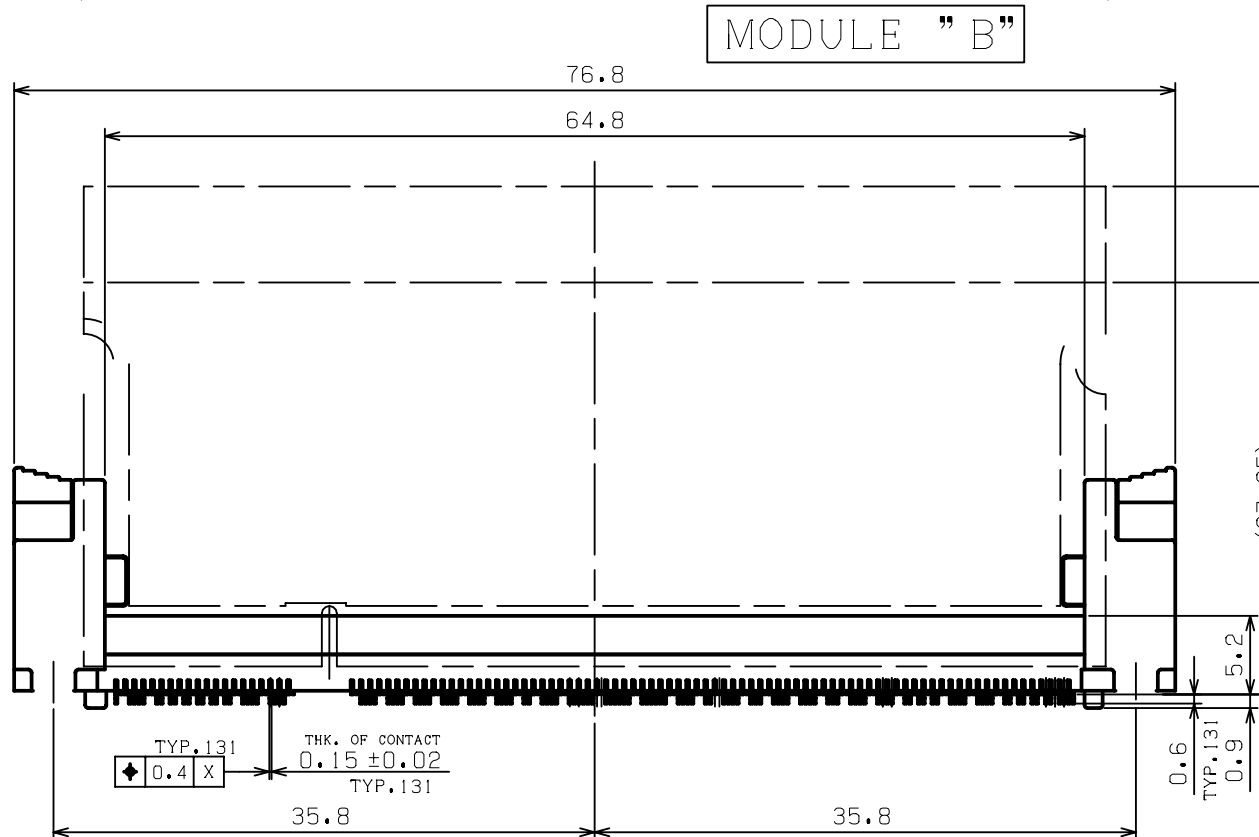
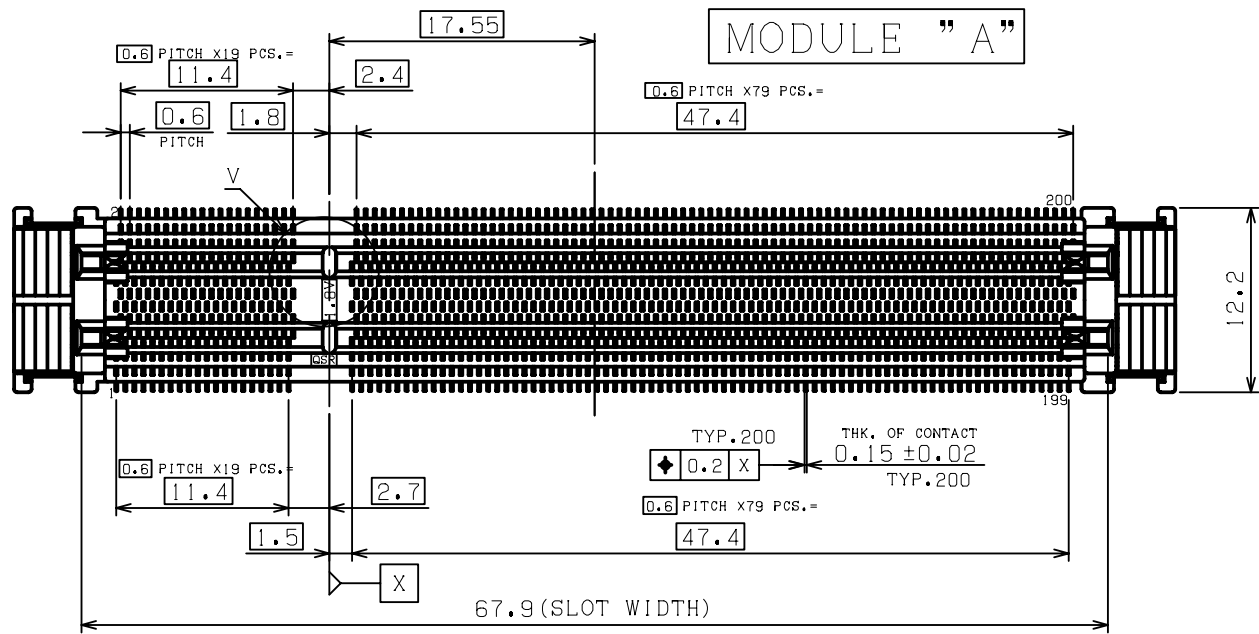

NOTE

- 1. 材料 : ハウジング : LCP UL94-V0  
 コンタクト : 銅合金  
 ラッチ : 高耐熱プラスチック UL94-V0  
 MATERIAL : HOUSING : LCP UL94-V0  
 CONTACT : COPPER ALLOY  
 LATCH : HIGH TEMPERATURE THERMOPLASTIC UL94V-0
- 2. コンタクトメッキ仕様:  
 金メッキ 0.0076μm min.厚  
 ニッケル下地 1.5μm min.厚  
 FINISH OF CONTACT : 0.0076μm min. GOLD PLATING  
 on 1.5μm min. ALL OVER NICKEL
- 3. 非累積公差  
 TOLERANCE NON-CUMULATIVE

△ コネクタを平坦面に置き、端子半田付け部半田付け部の厚きは、0.1mm以下  
 MUST BE MEASURED FLOATING AMOUNT OF CONTACT TAILS AND FROM DATUM SURFACE IS 0.1mm MAX.

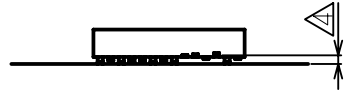

REV.	DESCRIPTION	DATE	DWG.	CHKD
0	RELEASED	'04/11/12	K.H	S.K
A	REVISED	'05/02/04	K.H	S.Y
B	REVISED	'05/03/10	K.H	S.Y
C	REVISED	'05/09/01	T.H	S.Y
D	REVISED	'05/10/12	T.H	S.Y
E	REVISED	'09.02.13	T.H	S.Y
F	REVISED	'12.06.28	T.H	S.Y

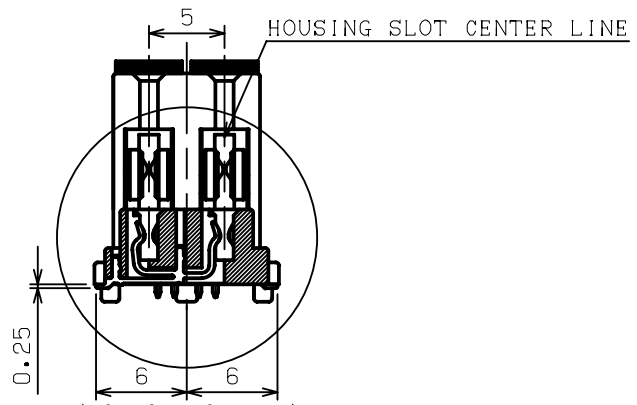

(COMMON CONTACT)  
 (69箇所: PIN NO. 2, 3, 8, 9, 12, 15, 18, 21, 24, 27, 28, 33, 34, 39, 40, 41, 42, 47, 48, 53, 54, 59, 60, 65, 66, 71, 72, 77, 78, 81, 82, 87, 88, 95, 96, 103, 104, 111, 112, 117, 118, 121, 122, 127, 128, 132, 133, 138, 139, 144, 145, 149, 150, 155, 156, 161, 162, 165, 168, 171, 172, 177, 178, 183, 184, 187, 190, 193, 196)

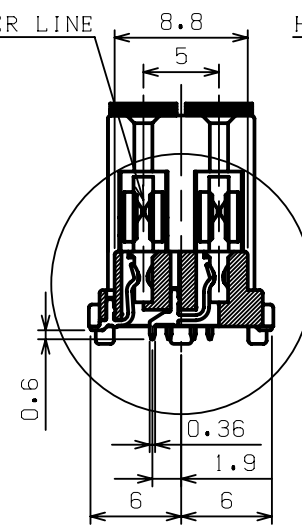

(SEPARATE CONTACT "1")  
 (66箇所 : PIN NO. 5, 6, 11, 16, 17, 22, 23, 26, 29, 32, 35, 38, 43, 46, 49, 52, 55, 56, 61, 62, 67, 68, 74, 75, 80, 85, 86, 90, 91, 94, 97, 100, 101, 105, 108, 109, 113, 114, 119, 124, 125, 130, 134, 137, 140, 143, 146, 147, 152, 153, 158, 159, 164, 169, 170, 174, 175, 180, 181, 186, 191, 192, 195, 198, 199)

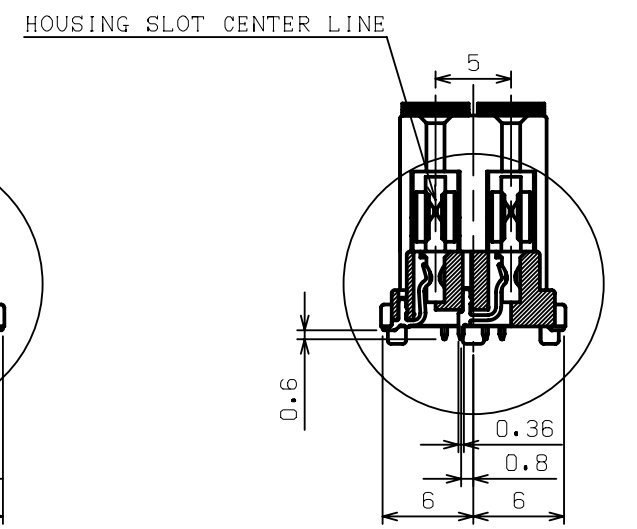

(SEPARATE CONTACT "2")  
 (65箇所 : PIN NO. 1, 4, 7, 10, 13, 14, 19, 20, 25, 30, 31, 36, 37, 44, 45, 50, 51, 57, 58, 63, 64, 69, 70, 73, 76, 79, 83, 84, 89, 92, 93, 98, 99, 102, 106, 107, 110, 115, 116, 120, 123, 126, 129, 135, 136, 141, 142, 148, 151, 154, 157, 160, 163, 166, 167, 173, 176, 179, 182, 185, 188, 189, 194, 197, 200)

CA0276-331N01	CA0276-331N61
CONNECTOR PARTS NO.	PART NO.

QTY PER ASSY					NOTE	FINISH	PART NO.	NAME		NO.
***	***	***	***	***	MATERIAL	NET WEIGHT	COLOR	GENERAL TOLERANCE		UNIT:mm
***	***	***	***	***	*****	***g	*****	±0.2 ±3°		
***	***	***	***	***	FIN.&TREAT	GROSS WEIGHT	SCALE	SIZE		
***	***	***	***	***	*****	***g	2/1	A3		
***	***	***	***	***	CUSTOMER	PART NO.		CA0276-331***		REV. F
***	***	***	***	***	CUSTOMER PART NO.	PROPOSAL NO.		*****		REV. *
***	***	***	***	***	QUASAR TECHNOLOGY		NAME		(SHEET 1 OF 5)	
***	***	***	***	***	APP. '04.11.12	CHKD '04.11.12	DWG. '04.11.12	DUAL DDR S.O.DIMM SOCKET		
***	***	***	***	***	S.YAMADA	S.KUBOUCHI	K.HAYASHI	331POS. VERTICAL TYPE		

REV.	DESCRIPTION	DATE	DWG.	CHKD
	SEE SHEET 1 OF 5			

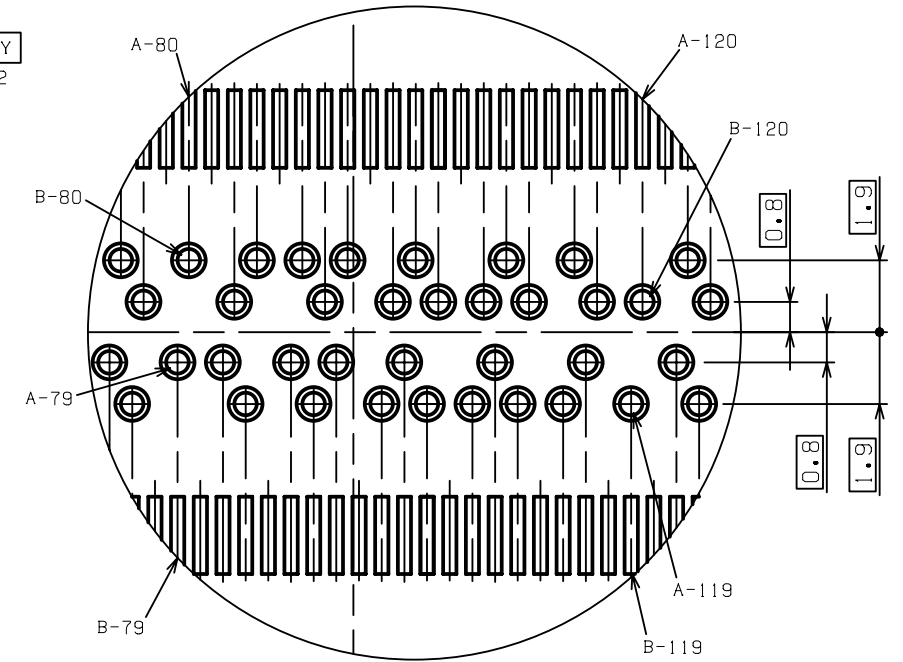
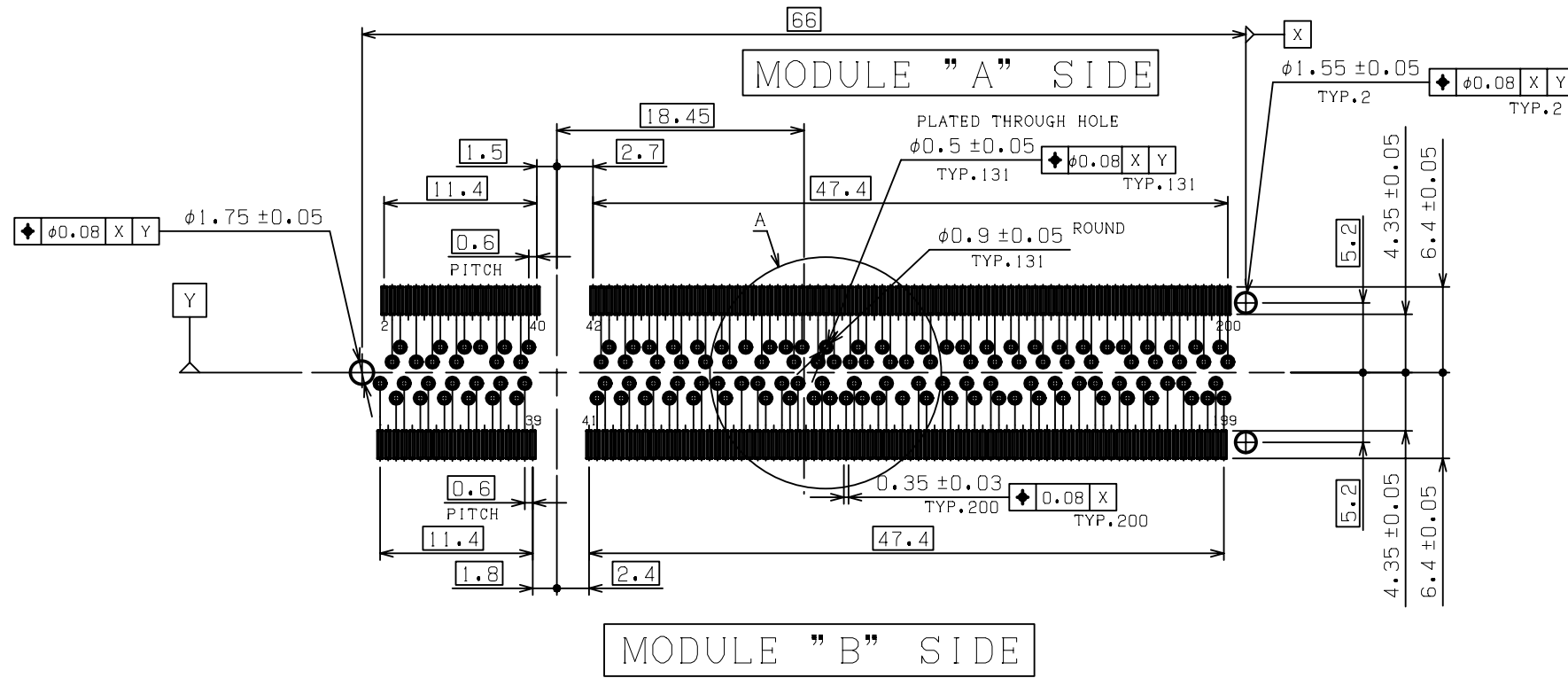

RECOMMENDED BOARD LAYOUT

DETAIL "A" (5/1)

QTY PER ASSY					NOTE	FINISH	PART NO.	NAME		NO.
***	***	***	***	***	MATERIAL	NET WEIGHT	COLOR	GENERAL TOLERANCE	UNIT:mm	
***	***	***	***	***	FIN.&TREAT	GROSS WEIGHT	SCALE	SIZE		
***	***	***	***	***	CUSTOMER		PART NO.	CA0276-331***		REV. F
***	***	***	***	***	CUSTOMER PART NO.		PROPOSAL NO.	*****		REV. *
***	***	***	***	***	QUASAR TECHNOLOGY		NAME	(SHEET 2 OF 5)		
***	***	***	***	***	APP. '04.11.12	CHKD '04.11.12	DWG. '04.11.12	DUAL DDR S.O.DIMM SOCKET		
***	***	***	***	***	S.YAMADA	S.KUBOUCHI	K.HAYASHI	331POS. VERTICAL TYPE		

REV.	DESCRIPTION	DATE	DWG.	CHKD
SEE SHEET 1 OF 5				

B-164	MODULE "B" No.164	CK1	B-107	MODULE "B" No.107	BA0
A-164	MODULE "A" No.164	CK1	A-107	MODULE "A" No.107	BA0
B-163	MODULE "B" No.163	NC TEST	B-106	MODULE "B" No.106	BA1
A-163	MODULE "A" No.163	NC TEST	A-106	MODULE "A" No.106	BA1
B-160	MODULE "B" No.160	DQ53	B-105	MODULE "B" No.105	A10/AP
A-160	MODULE "A" No.160	DQ53	A-105	MODULE "A" No.105	A10/AP
B-159	MODULE "B" No.159	DQ49	B-102	MODULE "B" No.102	A0
A-159	MODULE "A" No.159	DQ49	A-102	MODULE "A" No.102	A0
B-158	MODULE "B" No.158	DQ52	B-101	MODULE "B" No.101	A1
A-158	MODULE "A" No.158	DQ52	A-101	MODULE "A" No.101	A1
B-157	MODULE "B" No.157	DQ48	B-100	MODULE "B" No.100	A2
A-157	MODULE "A" No.157	DQ48	A-100	MODULE "A" No.100	A2
B-154	MODULE "B" No.154	DQ47	B-99	MODULE "B" No.99	A3
A-154	MODULE "A" No.154	DQ47	A-99	MODULE "A" No.99	A3
B-153	MODULE "B" No.153	DQ43	B-98	MODULE "B" No.98	A4
A-153	MODULE "A" No.153	DQ43	A-98	MODULE "A" No.98	A4
B-152	MODULE "B" No.152	DQ46	B-97	MODULE "B" No.97	A5
A-152	MODULE "A" No.152	DQ46	A-97	MODULE "A" No.97	A5
B-151	MODULE "B" No.151	DQ42	B-94	MODULE "B" No.94	A6
A-151	MODULE "A" No.151	DQ42	A-94	MODULE "A" No.94	A6
B-148	MODULE "B" No.148	DQS5	B-93	MODULE "B" No.93	A8
A-148	MODULE "A" No.148	DQS5	A-93	MODULE "A" No.93	A8
B-147	MODULE "B" No.147	DM5	B-92	MODULE "B" No.92	A7
A-147	MODULE "A" No.147	DM5	A-92	MODULE "A" No.92	A7
B-146	MODULE "B" No.146	DQS5	B-91	MODULE "B" No.91	A9
A-146	MODULE "A" No.146	DQS5	A-91	MODULE "A" No.91	A9
B-143	MODULE "B" No.143	DQ41	B-90	MODULE "B" No.90	A11
A-143	MODULE "A" No.143	DQ41	A-90	MODULE "A" No.90	A11
B-142	MODULE "B" No.142	DQ45	B-89	MODULE "B" No.89	A12
A-142	MODULE "A" No.142	DQ45	A-89	MODULE "A" No.89	A12
B-141	MODULE "B" No.141	DQ40	B-86	MODULE "B" No.86	NC/A14
A-141	MODULE "A" No.141	DQ40	A-86	MODULE "A" No.86	NC/A14
B-140	MODULE "B" No.140	DQ44	B-85	MODULE "B" No.85	BA2
A-140	MODULE "A" No.140	DQ44	A-85	MODULE "A" No.85	BA2
B-137	MODULE "B" No.137	DQ35	B-84	MODULE "B" No.84	NC/A15
A-137	MODULE "A" No.137	DQ35	A-84	MODULE "A" No.84	NC/A15
B-136	MODULE "B" No.136	DQ39	B-83	MODULE "B" No.83	NC
A-136	MODULE "A" No.136	DQ39	A-83	MODULE "A" No.83	NC
B-135	MODULE "B" No.135	DQ34	B-80	MODULE "B" No.80	NC/CKE1
A-135	MODULE "A" No.135	DQ34	A-80	MODULE "A" No.80	NC/CKE1
B-134	MODULE "B" No.134	DQ38	B-79	MODULE "B" No.79	CKE0
A-134	MODULE "A" No.134	DQ38	A-79	MODULE "A" No.79	CKE0
B-131	MODULE "B" No.131	DQS4	B-76	MODULE "B" No.76	DQ31
A-131	MODULE "A" No.131	DQS4	A-76	MODULE "A" No.76	DQ31
B-130	MODULE "B" No.130	DM4	B-75	MODULE "B" No.75	DQ27
A-130	MODULE "A" No.130	DM4	A-75	MODULE "A" No.75	DQ27
B-129	MODULE "B" No.129	DQS4	B-74	MODULE "B" No.74	DQ30
A-129	MODULE "A" No.129	DQS4	A-74	MODULE "A" No.74	DQ30
B-126	MODULE "B" No.126	DQ37	B-73	MODULE "B" No.73	DQ26
A-126	MODULE "A" No.126	DQ37	A-73	MODULE "A" No.73	DQ26
B-125	MODULE "B" No.125	DQ33	B-70	MODULE "B" No.70	DQS3
A-125	MODULE "A" No.125	DQ33	A-70	MODULE "A" No.70	DQS3
B-124	MODULE "B" No.124	DQ36	B-69	MODULE "B" No.69	NC
A-124	MODULE "A" No.124	DQ36	A-69	MODULE "A" No.69	NC
B-123	MODULE "B" No.123	DQ32	B-68	MODULE "B" No.68	DQS3
A-123	MODULE "A" No.123	DQ32	A-68	MODULE "A" No.68	DQS3
B-120	MODULE "B" No.120	NC	B-67	MODULE "B" No.67	DM3
A-120	MODULE "A" No.120	NC	A-67	MODULE "A" No.67	DM3
B-119	MODULE "B" No.119	NC/ODT1	B-64	MODULE "B" No.64	DQ29
A-119	MODULE "A" No.119	NC/ODT1	A-64	MODULE "A" No.64	DQ29
B-116	MODULE "B" No.116	NC/A13	B-63	MODULE "B" No.63	DQ25
A-116	MODULE "A" No.116	NC/A13	A-63	MODULE "A" No.63	DQ25
B-115	MODULE "B" No.115	NC/S1	B-62	MODULE "B" No.62	DQ28
A-115	MODULE "A" No.115	NC/S1	A-62	MODULE "A" No.62	DQ28
B-114	MODULE "B" No.114	ODT0	B-61	MODULE "B" No.61	DQ24
A-114	MODULE "A" No.114	ODT0	A-61	MODULE "A" No.61	DQ24
B-113	MODULE "B" No.113	CAS	B-58	MODULE "B" No.58	DQ23
A-113	MODULE "A" No.113	CAS	A-58	MODULE "A" No.58	DQ23
B-110	MODULE "B" No.110	SO	B-57	MODULE "B" No.57	DQ19
A-110	MODULE "A" No.110	SO	A-57	MODULE "A" No.57	DQ19
B-109	MODULE "B" No.109	WE	B-56	MODULE "B" No.56	DQ22
A-109	MODULE "A" No.109	WE	A-56	MODULE "A" No.56	DQ22
B-108	MODULE "B" No.108	RAS	B-55	MODULE "B" No.55	Q18
A-108	MODULE "A" No.108	RAS	A-55	MODULE "A" No.55	Q18

BOARD LAYOUT PIN No. (SEPARATE PART)	MODULE PIN No.	MODULE PIN NAME DDR2 S.O.DIMM	BOARD LAYOUT PIN No. (SEPARATE PART)	MODULE PIN No.	MODULE PIN NAME DDR2 S.O.DIMM	BOARD LAYOUT PIN No. (SEPARATE PART)	MODULE PIN No.	MODULE PIN NAME DDR2 S.O.DIMM	BOARD LAYOUT PIN No. (SEPARATE PART)	MODULE PIN No.	MODULE PIN NAME DDR2 S.O.DIMM
--------------------------------------	----------------	-------------------------------	--------------------------------------	----------------	-------------------------------	--------------------------------------	----------------	-------------------------------	--------------------------------------	----------------	-------------------------------

VSS : MODULE PIN No.2, 3, 8, 9, 12, 15, 18, 21, 24, 27, 28, 33, 34, 39, 40, 41, 42, 47, 48, 53, 54, 59, 60, 65, 66, 71, 72, 77, 78, 121, 122, 127, 128, 132, 133, 138, 139, 144, 145, 149, 150, 155, 156, 161, 162, 165, 168, 171, 172, 177, 178, 183, 184, 187, 190, 193, 196.

VDD : MODULE PIN No.81, 82, 87, 88, 95, 96, 103, 104, 111, 112, 117, 118.

QTY PER ASSY					NOTE	FINISH	PART NO.	NAME		NO.	
※	※	※	※	※	MATERIAL	*****	NET WEIGHT	*****	GENERAL TOLERANCE	UNIT:mm	
※	※	※	※	※	FIN.&TREAT	*****	GROSS WEIGHT	2/1	SIZE	A3	
※	※	※	※	※	CUSTOMER	*****	PART NO.	CA0276-331***		REV. F	
※	※	※	※	※	CUSTOMER PART NO.	*****	PROPOSAL NO.	*****		REV. *	
※	※	※	※	※	QUASAR TECHNOLOGY					NAME (SHEET 3 OF 5)	
※	※	※	※	※	APP. '04.11.12	CHKD '04.11.12	DWG. '04.11.12	DUAL DDR S.O.DIMM SOCKET			
※	※	※	※	※	S.YAMADA	S.KUBOUCHI	K.HAYASHI	331POS. VERTICAL TYPE			

REV.	DESCRIPTION	DATE	DWG.	CHKD
	SEE SHEET 1 OF 5			

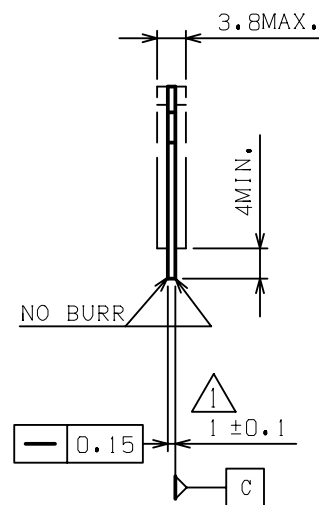
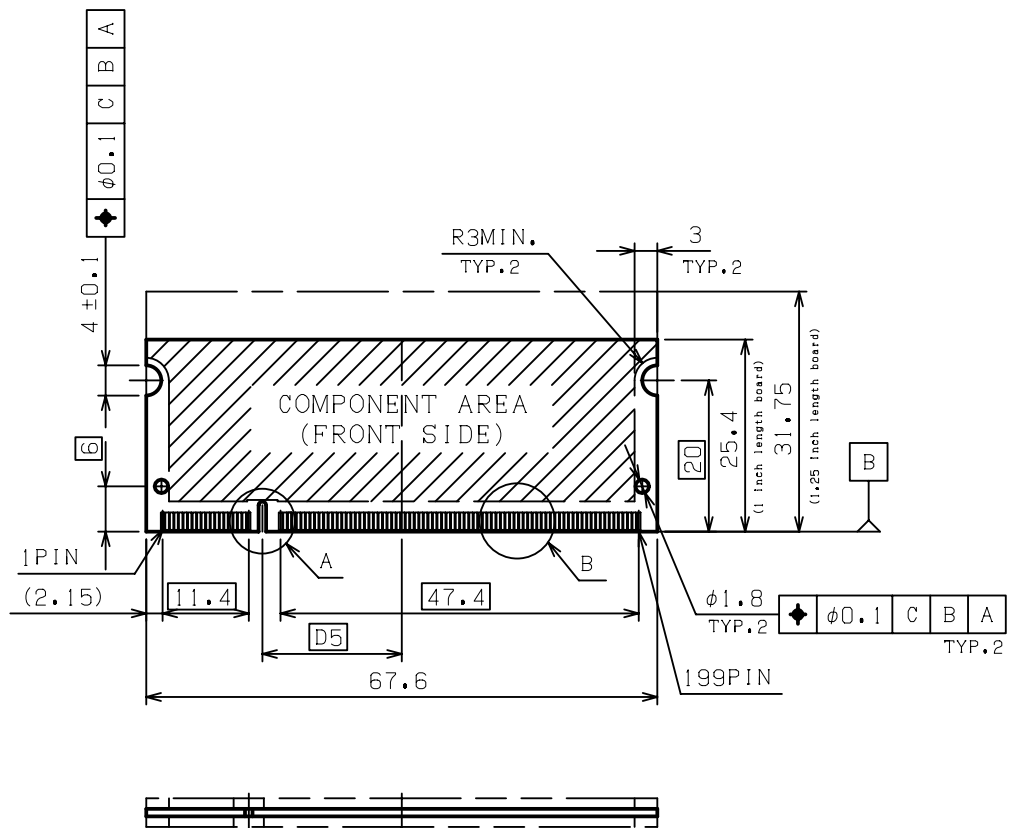

NOTES; (APPLIED TO SHEET 4 OF 6)

- 1. PC BOARD THICKNESS APPLIES ACROSS TABS AND INCLUDES PLATING AND/OR METALIZATION.
- 2. FINISH OF PAD : GOLD PLATING 0.00076 min. OVER NI PLATING 0.002 min.

注記; (SHEET 4 OF 6 に適用)

- 1. 基板厚寸法は、メッキ厚を含む。
- 2. パッド部の仕上げニッケル下地メッキ 0.002 min. の上に金メッキ 0.00076 min. 厚を施す。

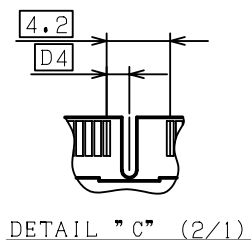

DETAIL "C" (2/1)

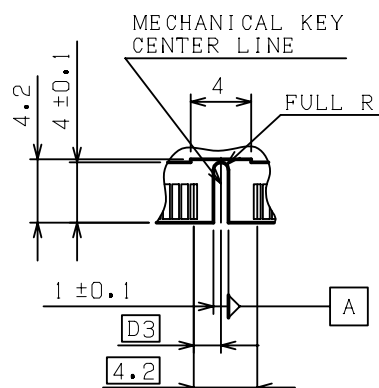
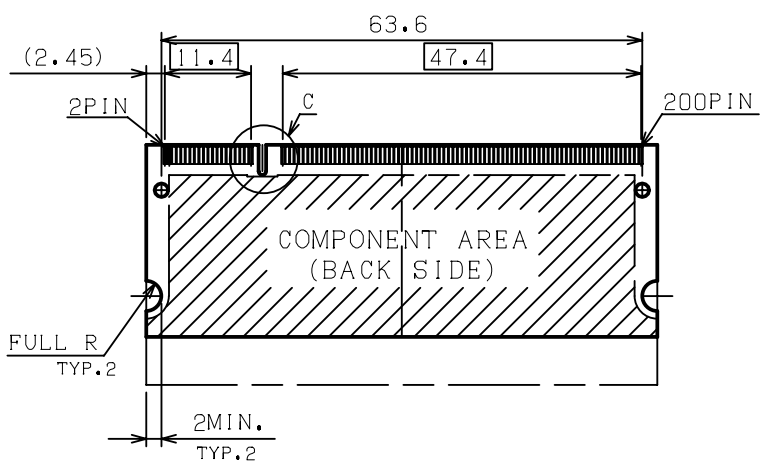

DETAIL "A" (2/1)

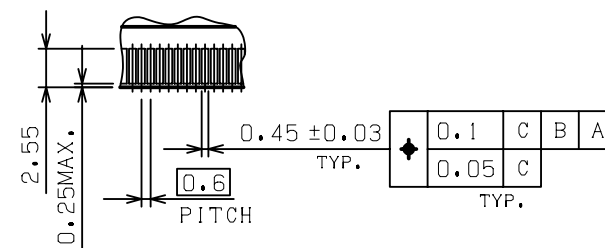

DETAIL "B" (2/1)

1.8V	17.55	2.4	2.7
2.5V	18.45	1.5	1.8
POWER SUPPLY	D5	D4	D3

QTY PER ASSY					NOTE	FINISH	PART NO.	NAME		NO.
**	**	**	**	**	MATERIAL	NET WEIGHT	COLOR	GENERAL TOLERANCE		UNIT:mm
**	**	**	**	**	*****	***g	*****	±0.08 ±1°		□ ⊙
-	-	-	-	-	FIN.&TREAT	GROSS WEIGHT	SCALE	SIZE		
**	**	**	**	**	*****	***g	2/1	A3		
**	**	**	**	**	CUSTOMER	PART NO.		CA0276-331***		REV. F
**	**	**	**	**	*****	PROPOSAL NO.		*****		REV. *
**	**	**	**	**	CUSTOMER PART NO.	NAME		(SHEET 4 OF 5)		
**	**	**	**	**	*****	QUASAR TECHNOLOGY		DUAL DDR S.O.DIMM SOCKET		
**	**	**	**	**	APP. '04.11.12	CHKD '04.11.12	DWG. '04.11.12	331POS. VERTICAL TYPE		
**	**	**	**	**	S.YAMADA	S.KUBOUCHI	K.HAYASHI			

6

5

4

3

2

1

REV.	DESCRIPTION	DATE	DWG.	CHKD
	SEE SHEET 1 OF 5			

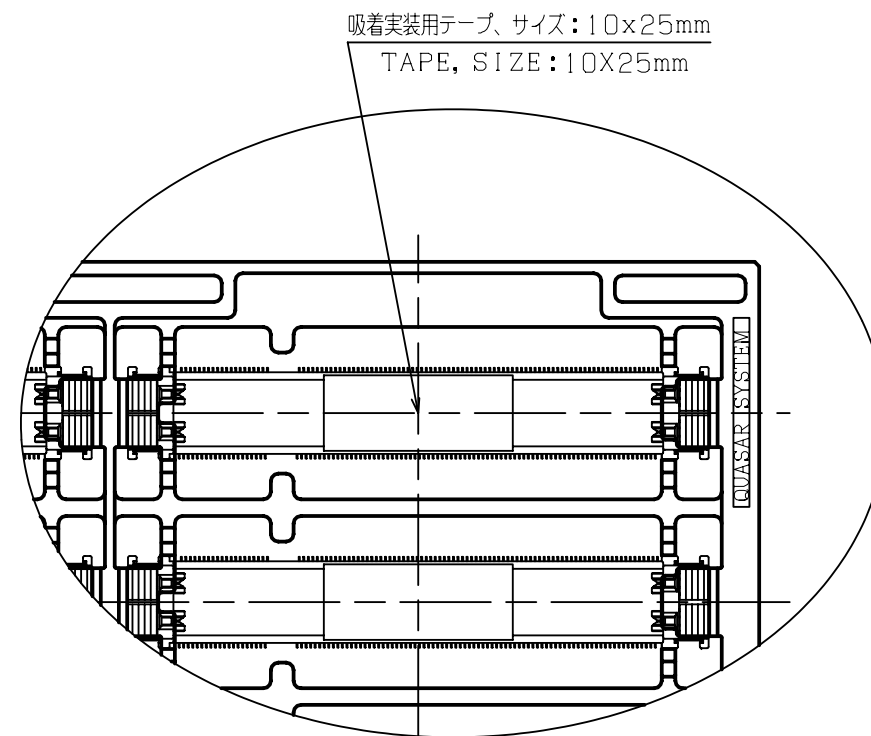
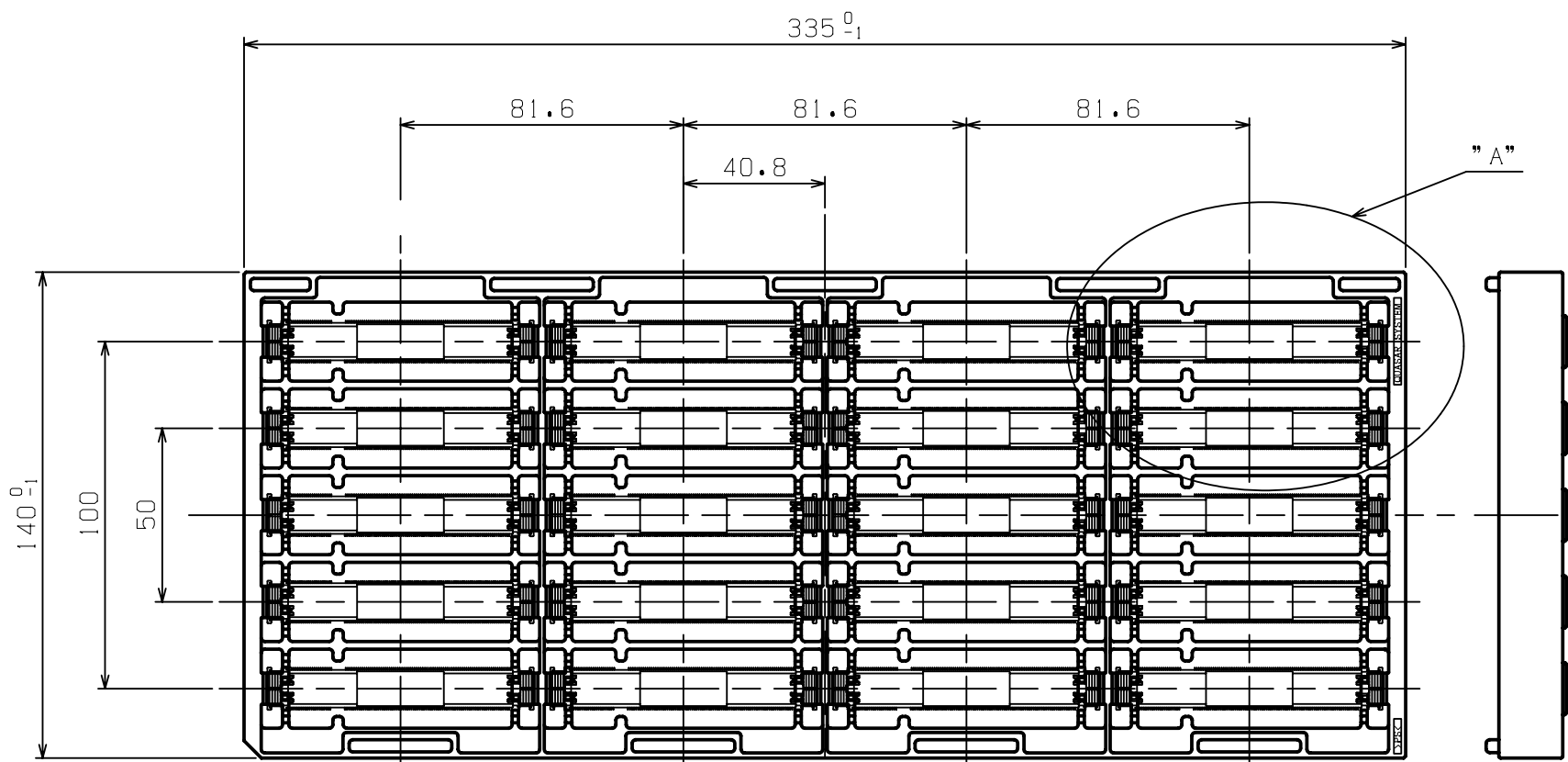

DETAIL "A"  
(SCALE 1/1)

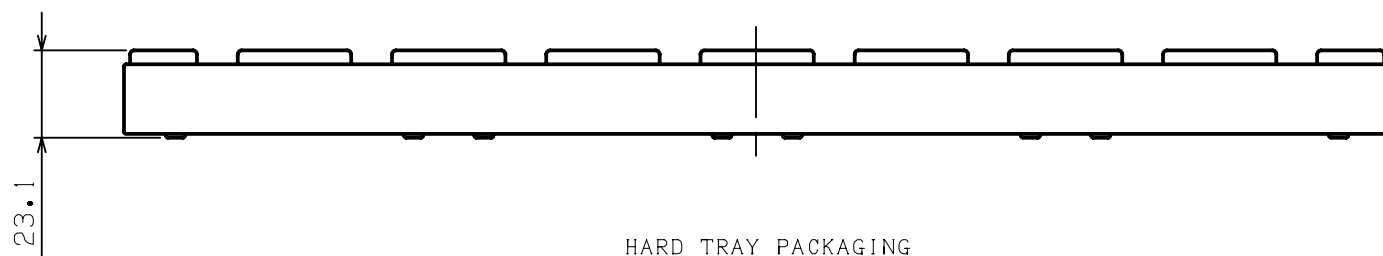

HARD TRAY PACKAGING

QTY PER ASSY					NOTE	FINISH	PART NO.	NAME		NO.	
**	**	**	**	**	MATERIAL	*****	NET WEIGHT	COLOR	GENERAL TOLERANCE	UNIT:mm □ ⊕	
**	**	**	**	**	FIN.&TREAT	*****	***g	*****	±0.08 ±1°		
-	-	-	-	-	CUSTOMER	*****	GROSS WEIGHT	SCALE	SIZE	REV. F	
**	**	**	**	**	CUSTOMER PART NO.	*****	***g	2/1	A3		
**	**	**	**	**				PART NO.	CA0276-331***		REV. *
**	**	**	**	**				PROPOSAL NO.	*****		
**	**	**	**	**	QUASAR TECHNOLOGY			NAME			(SHEET 5 OF 5)
**	**	**	**	**	APP. '04.11.12 S.YAMADA			CHKD '04.11.12 S.KUBOUCHI			DUAL DDR S.O.DIMM SOCKET
**	**	**	**	**	DWG. '04.11.12 K.HAYASHI			331POS. VERTICAL TYPE			(CUSTOMER DRAWING)